

The Timken Company

4500 Mt Pleasant St. NW

N. Canton, OH 44720

Phone: (234) 262-3000

E-Mail: CustomerCAD@timken.com • **Web site:** www.timken.com
Part Number 16005-ZZ, Narrow Section Ball Bearings (16000, 16100)

Timken's deep groove ball bearings deliver reliable performance in a wide range of applications and conditions. With super-finished raceways and controlled geometries, our premium design helps ensure consistent quality.

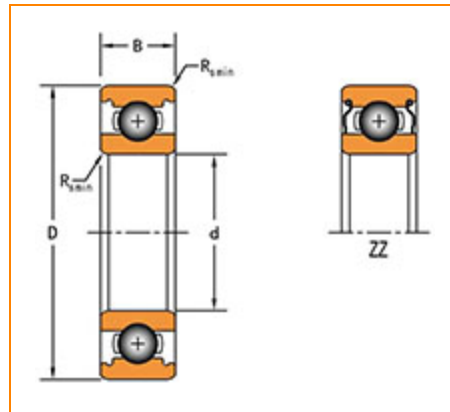

[Specifications](#) | [Dimensions](#) | [Basic Load Ratings](#) | [Factors](#)

Specifications

Clearance	C0 (Normal)
Bore Size d	25 mm
Features	Shields

Dimensions

Outside Diameter D	47 mm
Outside Ring Width B	8 mm
Radius Rs min	0.3 mm



Basic Load Ratings

Cr - Dynamic Load Rating 7000 N

C0r - Static Load Rating 4600 N

Factors

Grease Limiting Speed 11000 rpm

Oil Reference Speed 16000 rpm

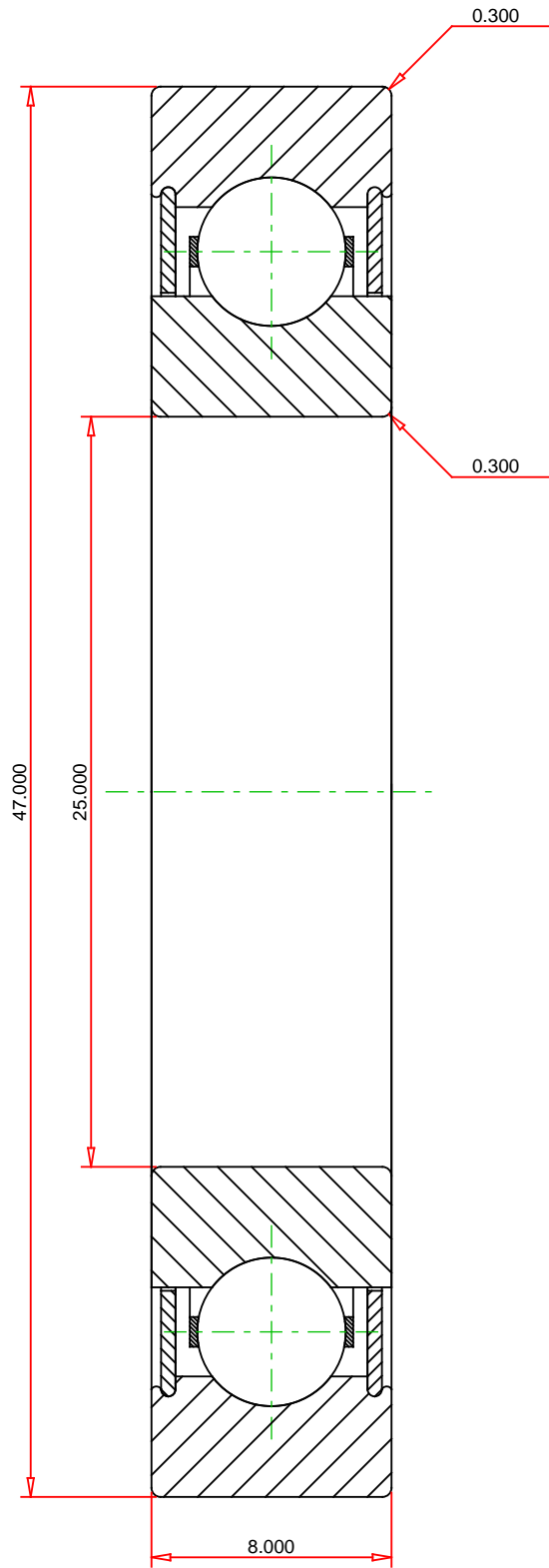

METRIC UNITS

Weight 0.06 kg

TIMKEN®

16005-ZZ
Narrow Section Ball Bearings (16000, 16100)

THE TIMKEN COMPANY
NORTH CANTON, OHIO USA

Dynamic Load Rating 7000 N
Static Load Rating 4600 N

Every reasonable effort has been made to ensure the accuracy of the information contained in this writing, but no liability is accepted for errors, omissions or for any other reason.

FOR DISCUSSION ONLY